



TOWN OF MENDON
BOARD OF ASSESSORS
20 MAIN STREET
MENDON, MA 01756
508-473-2738
508-478-8241 (Fax)
e-mail: assessor@mendonma.gov

May 19, 2022

*PROPERTY LOCATION(S): 44 Milford Street
Mendon, Massachusetts
Assessor's Map #9-177-44*

PROPERTY OWNER(S): Mendon SMC Realty LLC

*OWNER(S) ADDRESS: 50 Milford Street
Mendon, MA 01756*

*RECORDED: Worcester Registry of Deeds
August 9, 2019
Book #60858
Page #86*

The attached 300' abutter's list is true and accurate to the best of our knowledge.

Sincerely,

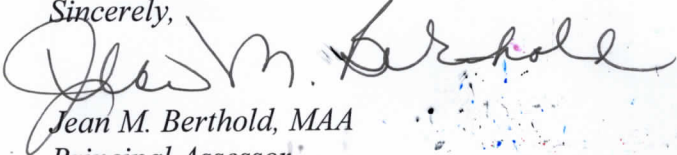

Jean M. Berthold, MAA
Principal Assessor

Attachment

**This list is valid for 30 days from the date of certification.*

TOWN OF MENDON, MA
 BOARD OF ASSESSORS
 20 Main Street, Mendon, MA 01756

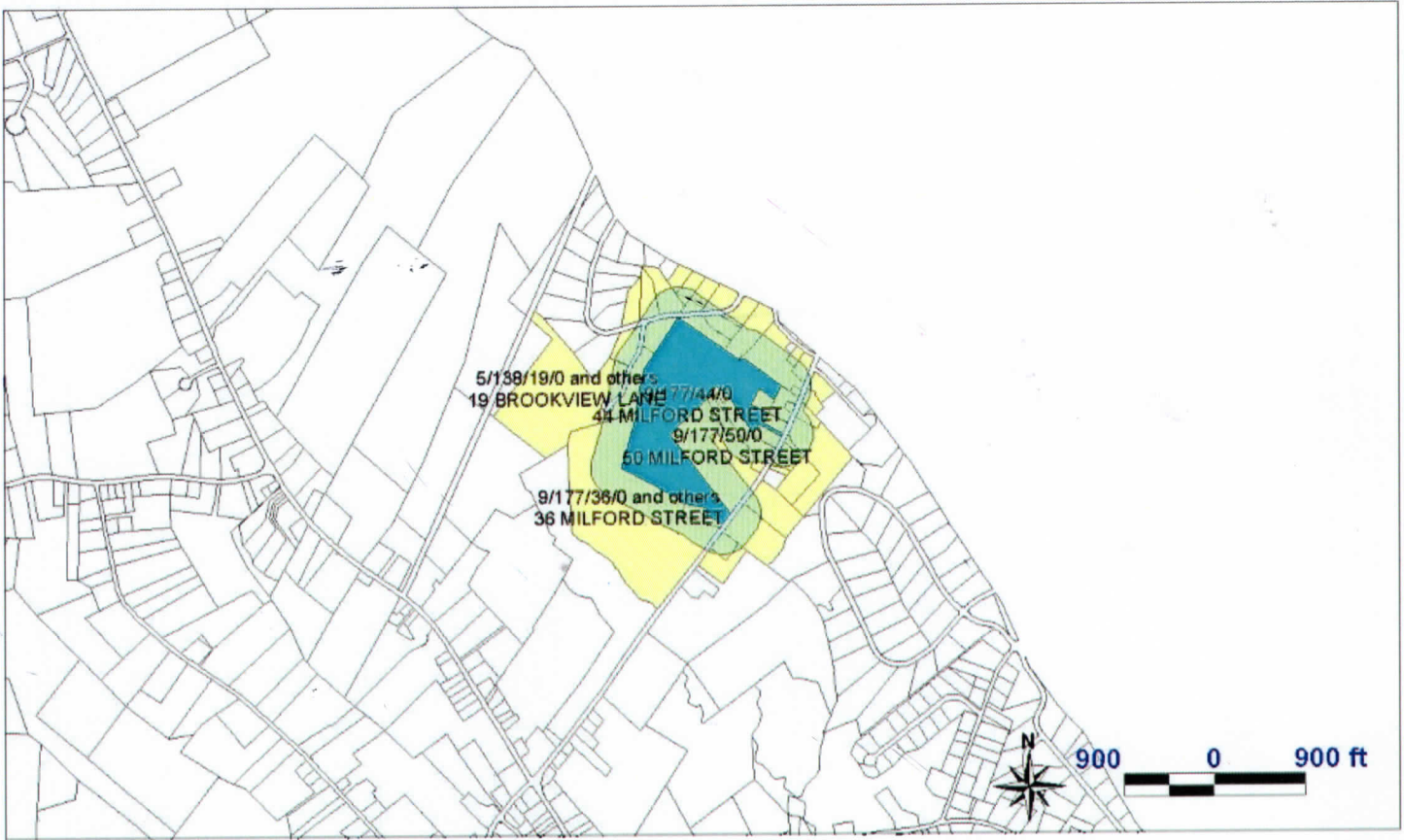
Abutters List Within 300 feet of Parcel 9/177/44/0



Key	Parcel ID	Owner	Location	Mailing Street	Mailing City	ST	ZipCd/Country
139	5-138-10-0-R	ISKANDER MINA	10 BROOKVIEW LANE	10 BROOKVIEW LANE	MENDON	MA	01756
3634	5-138-12-0-R	ORRELL TIMOTHY	12 BROOKVIEW LANE	12 BROOKVIEW LANE	MENDON	MA	01756
3635	5-138-14-0-R	AHMED KAZI FARZAN	14 BROOKVIEW LANE	14 BROOKVIEW LANE	MENDON	MA	01756
3636	5-138-15-0-R	DIAS JESSICA C	15 BROOKVIEW LANE	15 BROOKVIEW LANE	MENDON	MA	01756
3637	5-138-16-0-R	WARKENTIN MARSHALL	16 BROOKVIEW LANE	16 BROOKVIEW LANE	MENDON	MA	01756
3638	5-138-17-0-R	POWERS LORRAINE	17 BROOKVIEW LANE	17 BROOKVIEW LANE	MENDON	MA	01756
3639	5-138-18-0-R	SANCHES DENISE N	18 BROOKVIEW LANE	18 BROOKVIEW LANE	MENDON	MA	01756
3640	5-138-19-0-R	CAMPBELL JOHN & N/O CAMPBELL JOHN &	19 BROOKVIEW LANE	19 BROOKVIEW LANE	MENDON	MA	01756
3641	5-138-20-0-R	KELLEY KYLE P	20 BROOKVIEW LANE	20 BROOKVIEW LANE	MENDON	MA	01756
3642	5-138-21-0-R	DLUGASCH AMANDA	21 BROOKVIEW LANE	21 BROOKVIEW LANE	MENDON	MA	01756
3643	5-138-22-0-R	ALMEIDA CLAUDINE E	22 BROOKVIEW LANE	22 BROOKVIEW LANE	MENDON	MA	01756
3644	5-138-24-0-R	TEJEDA JOHN A	24 BROOKVIEW LANE	24 BROOKVIEW LANE	MENDON	MA	01756
3645	5-138-26-0-R	SAMIR MAKARIOS & MAREN MIKHAIL	26 BROOKVIEW LANE	26 BROOKVIEW LANE	MENDON	MA	01756
3646	5-138-28-0-R	GODSWILL ONYEDIKACHI & KAREN OGUGUA ENEBECHI	28 BROOKVIEW LANE	28 BROOKVIEW LANE	MENDON	MA	01756
3647	5-138-30-0-R	KOLLI NAREN VISWANATH RENUKA SUDHAMSA KOGANTI	30 BROOKVIEW LANE	30 BROOKVIEW LANE	MENDON	MA	01756

Key	Parcel ID	Owner	Location	Mailing Street	Mailing City	ST	ZipCd/Country
3648	5-138-31-0-R	FAIR MIKAELA	31 BROOKVIEW LANE	31 BROOKVIEW LANE	MENDON	MA	01756
177	6-124-4-0-R	HOWARTH CAROL A TRUSTEE HOWARTH FAMILY TRUST	4 EIGHT ROD ROAD	4 EIGHT ROD ROAD	MENDON	MA	01756
179	6-124-12-0-R	GATELY THOMAS J & TANYA L	12 EIGHT ROD RD EXT	6 WESTCOTT ROAD	HOPEDALE	MA	01747
180	6-124-16-0-R	SOARES DANIEL E & JUDITH C	16 EIGHT ROD RD EXT	8 WESTCOTT ROAD	HOPEDALE	MA	01747
181	6-124-18-0-R	D'URSO THOMAS R & DEIRDRE M	18 EIGHT ROD RD EXT	10 WESTCOTT ROAD	HOPEDALE	MA	01747
182	6-124-20-0-R	GILMORE-CAICO BETH A	20 EIGHT ROD RD EXT	12 WESTCOTT ROAD	HOPEDALE	MA	01747
183	6-124-22-0-R	SANTIAGO-CRUZ WILTRE R & NATHALIE	22 EIGHT ROD RD EXT	14 WESTCOTT ROAD	HOPEDALE	MA	01747
184	6-124-24-0-R	CHAPLIN III ERNEST R & PALMINA M	24 EIGHT ROD RD EXT	16 WESTCOTT ROAD	HOPEDALE	MA	01747
2855	6-129-2-0-R	BREEN KRISTIE S	2 DUDLEY ROAD	2 DUDLEY ROAD	MENDON	MA	01756
2856	6-129-4-0-R	VAZQUEZ RAFAEL & LILIA	4 DUDLEY ROAD	4 DUDLEY ROAD	MENDON	MA	01756
2857	6-129-5-0-R	LANDERS BRENDAN MICHAEL & DARAH MARIE	5 DUDLEY ROAD	5 DUDLEY ROAD	MENDON	MA	01756
2858	6-129-6-0-R	WILLIS MARK B TRUSTEE 1/2 WENDY L WILLIS TRUSTEE 1/2	6 DUDLEY ROAD	6 DUDLEY ROAD	MENDON	MA	01756
2859	6-129-7-0-R	KING LOUIE & ELISA	7 DUDLEY ROAD	7 DUDLEY ROAD	MENDON	MA	01756
2860	6-129-8-0-R	MASSAROCO CHRISTOPHER & JESSICA	8 DUDLEY ROAD	8 DUDLEY ROAD	MENDON	MA	01756
2861	6-129-9-0-R	TURI RICHARD E & GLORIA J	9 DUDLEY ROAD	9 DUDLEY ROAD	MENDON	MA	01756
207	6-177-5-A-R	BOUCHARD PAUL E ET AL	5-A MILFORD STREET (OFF)	101 HARTFORD AVENUE WEST	MENDON	MA	01756
208	6-177-7-1-R	SPENCE DAVID M & NATALIA	7-1 MILFORD STREET (OFF)	56 MILFORD STREET	MENDON	MA	01756
209	6-177-58-0-R	VINCENT WILLIAM A & LEBLANC MARGARET M	58 MILFORD STREET	58 MILFORD STREET	MENDON	MA	01756
3224	6-177-59-0-R	YATES SUSAN M (ESTATE) & N/O WHEELWRIGHT RICHARD	59 MILFORD STREET	59 MILFORD STREET	MENDON	MA	01756
210	6-177-60-0-R	HACKENSON TODD J	60 MILFORD STREET	60 MILFORD STREET	MENDON	MA	01756
211	6-177-61-0-R	RUA ELAINE A	61 MILFORD STREET	61 MILFORD STREET	MENDON	MA	01756-0108
3304	6-177-62-A-R	ROSE STACY M & GREGORY JR	62-A MILFORD STREET	62 MILFORD STREET	MENDON	MA	01756
212	6-177-62-B-R	PAIVA RENATA	62-B MILFORD STREET	66 MILFORD STREET	MENDON	MA	01756
213	6-177-63-0-R	LARSON PAUL J JR	63 MILFORD STREET	63 MILFORD STREET	MENDON	MA	01756
214	6-177-64-0-R	O'GRADY FAMILY IRREVOCABLE TRUST (THE)	64 MILFORD STREET	42 MILFORD STREET	MENDON	MA	01756
215	6-177-65-0-R	DETERMINATION INC	65 MILFORD STREET	P O BOX 444	MENDON	MA	01756-0444
216	6-177-68-0-R	HOWARTH CAROL A TRUSTEE HOWARTH FAMILY TRUST	68 MILFORD STREET	4 EIGHT ROD ROAD	MENDON	MA	01756
217	6-177-69-0-R	DETERMINATION INC	69 MILFORD STREET	P O BOX 444	MENDON	MA	01756-0444
218	6-177-70-0-R	HOWARTH CAROL A TRUSTEE HOWARTH FAMILY TRUST	70 MILFORD STREET	4 EIGHT ROD ROAD	MENDON	MA	01756
222	6-177-78-0-R	HOWARTH CAROL A TRUSTEE HOWARTH FAMILY TRUST	78 MILFORD STREET	4 EIGHT ROD ROAD	MENDON	MA	01756
556	9-177-36-0-E	TOWN OF MENDON	36 MILFORD STREET	20 MAIN STREET	MENDON	MA	01756
3520	9-177-36-S-R	TOWN OF MENDON C/O BWC MYSTIC RIVER LLC	36 MILFORD STREET	AMERESCO - SHERRIE BROGAN 111 SPEEN ST - STE 410	FRAMINGHAM	MA	01701
558	9-177-41-0-R	ANNA CORPORATION	41 MILFORD STREET	P. O. BOX 553	MILFORD	MA	01757
559	9-177-42-0-R	GHELLI ENRICO H & PATRICIA TRUSTEES GHELLI FAMILY RT	42 MILFORD STREET	42 MILFORD STREET	MENDON	MA	01756
560	9-177-43-0-R	WORCESTER COUNTY ELECTRIC CO C/O PROPERTY TAX DEPARTMENT	43 MILFORD STREET	40 SYLVAN ROAD	WALTHAM	MA	02451-2286
561	9-177-44-0-R	MENDON SMC REALTY LLC	44 MILFORD STREET	50 MILFORD STREET	MENDON	MA	01756
562	9-177-47-0-R	CANNAPRENEUR PARTNERS LLC	47 MILFORD STREET	110 TURNPIKE ROAD SUITE 114	WESTBOROUGH	MA	01581
563	9-177-49-0-R	FUNARI GEORGE C TRUSTEE LANDMARK REALTY TRUST II	49 MILFORD STREET	297 BOSTON ROAD	SUTTON	MA	01590
566	9-177-50-0-R	SWEET ROBERT & LAURIE A TRSTES SWEET LIVING TRUST	50 MILFORD STREET	50 MILFORD STREET	MENDON	MA	01756
567	9-177-53-0-R	ROSSETTI ROBERT J C/O ROSSETTI ROBERT A	53 MILFORD STREET	39 VEERY ROAD	ATTLEBORO	MA	02703
568	9-177-54-0-R	MAY LISA M	54 MILFORD STREET	264 SOUTH MAIN STREET	HOPEDALE	MA	01747

Key	Parcel ID	Owner	Location	Mailing Street	Mailing City	ST	ZipCd/Country
569	9-177-55-0-R	GRILLO JAMES J N/O GRILLO JAMES J &	55 MILFORD STREET	55 MILFORD STREET	MENDON	MA	01756
570	9-177-56-0-R	SPENCE DAVID M & NATALIA	56 MILFORD STREET	56 MILFORD STREET	MENDON	MA	01756
571	9-177-57-0-R	LARSON PAUL J & MARIAN C	57 MILFORD STREET	57 MILFORD STREET	MENDON	MA	01756

5-138-10-0	ISKANDER MINA 10 BROOKVIEW LANE MENDON, MA 01756	5-138-12-0	ORRELL TIMOTHY 12 BROOKVIEW LANE MENDON, MA 01756	5-138-14-0	AHMED KAZI FARZAN 14 BROOKVIEW LANE MENDON, MA 01756
5-138-15-0	DIAS JESSICA C 15 BROOKVIEW LANE MENDON, MA 01756	5-138-16-0	WARKENTIN MARSHALL 16 BROOKVIEW LANE MENDON, MA 01756	5-138-17-0	POWERS LORRAINE 17 BROOKVIEW LANE MENDON, MA 01756
5-138-18-0	SANCHES DENISE N 18 BROOKVIEW LANE MENDON, MA 01756	5-138-19-0	CAMPBELL JOHN & SASHA LINDO-CAMPBELL 19 BROOKVIEW LANE MENDON, MA 01756	5-138-20-0	KELLEY KYLE P 20 BROOKVIEW LANE MENDON, MA 01756
5-138-21-0	DLUGASCH AMANDA 21 BROOKVIEW LANE MENDON, MA 01756	5-138-22-0	ALMEIDA CLAUDINE E 22 BROOKVIEW LANE MENDON, MA 01756	5-138-24-0	TEJEDA JOHN A 24 BROOKVIEW LANE MENDON, MA 01756
5-138-26-0	SAMIR MAKARIOS & MAREN MIKHAIL 26 BROOKVIEW LANE MENDON, MA 01756	5-138-28-0	GODSWILL ONYEDIKACHI & KAREN OGUGUA ENEBECHI 28 BROOKVIEW LANE MENDON, MA 01756	5-138-30-0	KOLLI NAREN VISWANATH RENUKA SUDHAMSA KOGANTI 30 BROOKVIEW LANE MENDON, MA 01756
5-138-31-0	FAIR MIKAELA 31 BROOKVIEW LANE MENDON, MA 01756	6-124-4-0	HOWARTH CAROL A TRUSTEE HOWARTH FAMILY TRUST 4 EIGHT ROD ROAD MENDON, MA 01756	6-124-12-0	GATELY THOMAS J & TANYA L 6 WESTCOTT ROAD HOPEDALE, MA 01747
6-124-16-0	SOARES DANIEL E & JUDITH C 8 WESTCOTT ROAD HOPEDALE, MA 01747	6-124-18-0	D'URSO THOMAS R & DEIRDRE M 10 WESTCOTT ROAD HOPEDALE, MA 01747	6-124-20-0	GILMORE-CAICO BETH A 12 WESTCOTT ROAD HOPEDALE, MA 01747
6-124-22-0	SANTIAGO-CRUZ WILTRE R & NATHALIE 14 WESTCOTT ROAD HOPEDALE, MA 01747	6-124-24-0	CHAPLIN III ERNEST R & PALMINA M 16 WESTCOTT ROAD HOPEDALE, MA 01747	6-129-2-0	BREEN-KRISTIE S 2 DUDLEY ROAD MENDON, MA 01756
6-129-4-0	VAZQUEZ RAFAEL & LILIA 4 DUDLEY ROAD MENDON, MA 01756	6-129-5-0	LANDERS BRENDAN MICHAEL & DARAH MARIE 5 DUDLEY ROAD MENDON, MA 01756	6-129-6-0	WILLIS MARK B TRUSTEE 1/2 WENDY L WILLIS TRUSTEE 1/2 6 DUDLEY ROAD MENDON, MA 01756
6-129-7-0	KING LOUIE & ELISA 7 DUDLEY ROAD MENDON, MA 01756	6-129-8-0	MASSAROCO CHRISTOPHER & JESSICA 8 DUDLEY ROAD MENDON, MA 01756	6-129-9-0	TURI RICHARD E & GLORIA J 9 DUDLEY ROAD MENDON, MA 01756

6-177-5-A

BOUCHARD PAUL E ET AL
101 HARTFORD AVENUE WEST
MENDON, MA 01756

6-177-7-1

SPENCE DAVID M & NATALIA
56 MILFORD STREET
MENDON, MA 01756

6-177-58-0

VINCENT WILLIAM A
& LEBLANC MARGARET M
58 MILFORD STREET
MENDON, MA 01756

6-177-59-0

WHEELWRIGHT RICHARD
59 MILFORD STREET
MENDON, MA 01756

6-177-60-0

HACKENSON TODD J
60 MILFORD STREET
MENDON, MA 01756

6-177-61-0

RUA ELAINE A
61 MILFORD STREET
MENDON, MA 01756-0108

6-177-62-A

ROSE STACY M & GREGORY JR
62 MILFORD STREET
MENDON, MA 01756

6-177-62-B

PAIVA RENATA
66 MILFORD STREET
MENDON, MA 01756

6-177-63-0

LARSON PAUL J JR
63 MILFORD STREET
MENDON, MA 01756

6-177-64-0

O'GRADY FAMILY IRREVOCABLE
TRUST (THE)
42 MILFORD STREET
MENDON, MA 01756

6-177-65-0

DETERMINATION INC
P O BOX 444
MENDON, MA 01756-0444

9-177-36-0

TOWN OF MENDON
20 MAIN STREET
MENDON, MA 01756

9-177-41-0

ANNA CORPORATION
P. O. BOX 553
MILFORD, MA 01757

9-177-42-0

GHELLI ENRICO H & PATRICIA
TRUSTEES GHELLI FAMILY RT
42 MILFORD STREET
MENDON, MA 01756

9-177-43-0

WORCESTER COUNTY ELECTRIC CO
C/O PROPERTY TAX DEPARTMENT
40 SYLVAN ROAD
WALTHAM, MA 02451-2286

9-177-44-0

MENDON SMC REALTY LLC
50 MILFORD STREET
MENDON, MA 01756

9-177-47-0

CANNAPRENEUR PARTNERS LLC
110 TURNPIKE ROAD
SUITE 114
WESTBOROUGH, MA 01581

9-177-49-0

FUNARI GEORGE C TRUSTEE
LANDMARK REALTY TRUST II
297 BOSTON ROAD
SUTTON, MA 01590

9-177-53-0

ROSSETTI ROBERT J
C/O ROSSETTI ROBERT A
39 VEERY ROAD
ATTLEBORO, MA 02703

9-177-54-0

MAY LISA M
264 SOUTH MAIN STREET
HOPEDALE, MA 01747

9-177-55-0

GRILLO JAMES J &
ALEXANDRA S
55 MILFORD STREET
MENDON, MA 01756

9-177-56-0

SPENCE DAVID M & NATALIA
56 MILFORD STREET
MENDON, MA 01756

9-177-57-0

LARSON PAUL J
& MARIAN C
57 MILFORD STREET
MENDON, MA 01756