



Milford Office
333 West Street, P. O. Box 235
Milford, MA 01757-0235
(508) 473-6630/Fax (508) 473-8243

Franklin Office
55 West Central Street
Franklin, MA 02038-2101
(508) 528-3221/Fax (508) 528-7921

Whitinsville Office
1029 Providence Road
Whitinsville, MA 01588-2121
(508) 234-6834/Fax (508) 234-6723

March 3, 2020

Mendon Conservation Commission
20 Main Street
Mendon, MA 01756

RE: Notice of Intent – 41 Milford Street Mendon, MA

Dear Commission Members:

On behalf of the applicant, Anna Corporation, we are submitting a Notice of Intent for the construction of a 300' x 40' Self Storage Building along with associated access road around building, grading and utilities, within the 100 ft. buffer of a bordering vegetated wetlands. 1,012 sf of a wetlands fingerlike projection will be filled with 1,400 sf of bvw being replicated. Enclosed, please find two (2) copies of the Notice of Intent filing along with the appropriate filing fee.

As part of this filing, we are requesting a waiver from the no disturbance buffer to allow for the construction and grading of the detention structure.

We have filed one (1) copy of the Notice of Intent package with the Massachusetts Department of Environmental Protection, Central Region, 8 New Bond Street, Worcester, MA 01606 along with the required filing fee to D.E.P. in Boston.

Abutters are being notified of this filing, as required by the Wetlands Protection Act.

We look forward to working with your office on this project. If you have any questions regarding this filing, or if you need any more information, please do not hesitate to contact this office.

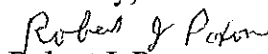
Sincerely,

Robert J. Poxon
Project Engineer

Enclosures



Guerriere & Halnon, Inc.

ENGINEERING & LAND SURVEYING
www.gandhengineering.com

Est. 1972

Milford Office
333 West Street, P. O. Box 235
Milford, MA 01757-0235
(508) 473-6630/Fax (508) 473-8243

Franklin Office
55 West Central Street
Franklin, MA 02038-2101
(508) 528-3221/Fax (508) 528-7921

Whitinsville Office
1029 Providence Road
Whitinsville, MA 01588-2121
(508) 234-6834/Fax (508) 234-6723

**Notice of Intent
For
Self Storage Building
41 Milford Street
In
Mendon, MA**

Date: March 3, 2020

Applicant:
*Anna Corporation
P.O. Box 553
Milford, MA 01757*

Prepared By:
*Guerriere & Halnon, Inc.
Engineering & Land Surveying
333 West Street
Milford, MA 01757*

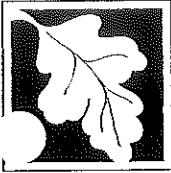

Massachusetts Department of Environmental Protection
Bureau of Resource Protection - Wetlands

Provided by MassDEP:

WPA Form 3 – Notice of Intent

Massachusetts Wetlands Protection Act M.G.L. c. 131, §40

MassDEP File Number

Document Transaction Number

Mendon

City/Town

Important:
When filling out forms on the computer, use only the tab key to move your cursor - do not use the return key.



Note:
Before completing this form consult your local Conservation Commission regarding any municipal bylaw or ordinance.

A. General Information

1. Project Location (Note: electronic filers will click on button to locate project site):

41 Milford Street	Mendon	01756
a. Street Address	b. City/Town	c. Zip Code
Latitude and Longitude:	42.113460	-71.547090
	d. Latitude	e. Longitude
9	41	
f. Assessors Map/Plat Number	g. Parcel /Lot Number	

2. Applicant:

Roy	Vaz	
a. First Name	b. Last Name	
Anna Corporation		
c. Organization		
P.O. Box 553		
d. Street Address		
Milford	MA	01757
e. City/Town	f. State	g. Zip Code
508-634-3176	royvaz74@yahoo.com	
h. Phone Number	i. Fax Number	j. Email Address

3. Property owner (required if different from applicant): Check if more than one owner

a. First Name	b. Last Name	
c. Organization		
d. Street Address		
e. City/Town	f. State	g. Zip Code
h. Phone Number	i. Fax Number	j. Email address

4. Representative (if any):

Robert	Poxon	
a. First Name	b. Last Name	
Guerriere & Halnon, Inc.		
c. Company		
333 West Street P.O. Box 235		
d. Street Address		
Milford	MA	01757-0235
e. City/Town	f. State	g. Zip Code
508-473-6630	508-473-8243	rpoxon@gandhengineering.com
h. Phone Number	i. Fax Number	j. Email address

5. Total WPA Fee Paid (from NOI Wetland Fee Transmittal Form):

\$1,050.00	\$512.50	\$537.50
a. Total Fee Paid	b. State Fee Paid	c. City/Town Fee Paid

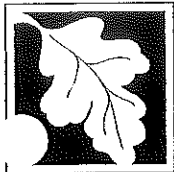

WPA Form 3 – Notice of Intent

Massachusetts Wetlands Protection Act M.G.L. c. 131, §40

MassDEP File Number

Document Transaction Number

Mendon

City/Town

A. General Information (continued)

6. General Project Description:

A 12000 s.f. storage building along the easterly side of lot with a 20 ft wide access drive around unit is proposed. There is approximately 2571 s.f of pavement and 1552 s.f. of the proposed building within the 100 ft buffer and 444 s.f of pavement falls in the no build area. There will be 1012 s.f. of wetland filling for drive and grading, 1400 s.f replication is proposed to mitigate the wetland filling.

7a. Project Type Checklist: (Limited Project Types see Section A. 7b.)

- 1. Single Family Home
- 2. Residential Subdivision
- 3. Commercial/Industrial
- 4. Dock/Pier
- 5. Utilities
- 6. Coastal engineering Structure
- 7. Agriculture (e.g., cranberries, forestry)
- 8. Transportation
- 9. Other

7b. Is any portion of the proposed activity eligible to be treated as a limited project (including Ecological Restoration Limited Project) subject to 310 CMR 10.24 (coastal) or 310 CMR 10.53 (inland)?

- 1. Yes No If yes, describe which limited project applies to this project. (See 310 CMR 10.24 and 10.53 for a complete list and description of limited project types)

2. Limited Project Type

If the proposed activity is eligible to be treated as an Ecological Restoration Limited Project (310 CMR 10.24(8), 310 CMR 10.53(4)), complete and attach Appendix A: Ecological Restoration Limited Project Checklist and Signed Certification.

8. Property recorded at the Registry of Deeds for:

Worcester

a. County

18965

c. Book

b. Certificate # (if registered land)

00190

d. Page Number

B. Buffer Zone & Resource Area Impacts (temporary & permanent)

- 1. Buffer Zone Only – Check if the project is located only in the Buffer Zone of a Bordering Vegetated Wetland, Inland Bank, or Coastal Resource Area.
- 2. Inland Resource Areas (see 310 CMR 10.54-10.58; if not applicable, go to Section B.3, Coastal Resource Areas).

Check all that apply below. Attach narrative and any supporting documentation describing how the project will meet all performance standards for each of the resource areas altered, including standards requiring consideration of alternative project design or location.

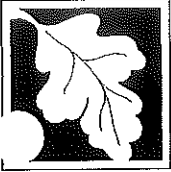

Massachusetts Department of Environmental Protection
 Bureau of Resource Protection - Wetlands
WPA Form 3 – Notice of Intent
 Massachusetts Wetlands Protection Act M.G.L. c. 131, §40

Provided by MassDEP:

MassDEP File Number

Document Transaction Number

Mendon

City/Town

B. Buffer Zone & Resource Area Impacts (temporary & permanent) (cont'd)

For all projects affecting other Resource Areas, please attach a narrative explaining how the resource area was delineated.

Resource Area	Size of Proposed Alteration	Proposed Replacement (if any)
a. <input type="checkbox"/> Bank	1. linear feet	2. linear feet
b. <input checked="" type="checkbox"/> Bordering Vegetated Wetland	1012 1. square feet	1400 2. square feet
c. <input type="checkbox"/> Land Under Waterbodies and Waterways	1. square feet 3. cubic yards dredged	2. square feet

Resource Area	Size of Proposed Alteration	Proposed Replacement (if any)
d. <input type="checkbox"/> Bordering Land Subject to Flooding	1. square feet 3. cubic feet of flood storage lost	2. square feet 4. cubic feet replaced
e. <input type="checkbox"/> Isolated Land Subject to Flooding	1. square feet 2. cubic feet of flood storage lost	3. cubic feet replaced
f. <input type="checkbox"/> Riverfront Area	1. Name of Waterway (if available) - specify coastal or inland	

2. Width of Riverfront Area (check one):

- 25 ft. - Designated Densely Developed Areas only
- 100 ft. - New agricultural projects only
- 200 ft. - All other projects

3. Total area of Riverfront Area on the site of the proposed project: _____ square feet

4. Proposed alteration of the Riverfront Area:

a. total square feet _____ b. square feet within 100 ft. _____ c. square feet between 100 ft. and 200 ft. _____

5. Has an alternatives analysis been done and is it attached to this NOI? Yes No

6. Was the lot where the activity is proposed created prior to August 1, 1996? Yes No

3. Coastal Resource Areas: (See 310 CMR 10.25-10.35)

Note: for coastal riverfront areas, please complete **Section B.2.f.** above.

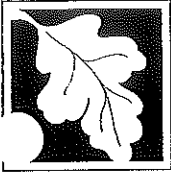

Massachusetts Department of Environmental Protection
 Bureau of Resource Protection - Wetlands
WPA Form 3 – Notice of Intent
 Massachusetts Wetlands Protection Act M.G.L. c. 131, §40

Provided by MassDEP:

MassDEP File Number _____

Document Transaction Number _____

Mendon _____

City/Town _____

B. Buffer Zone & Resource Area Impacts (temporary & permanent) (cont'd)

Check all that apply below. Attach narrative and supporting documentation describing how the project will meet all performance standards for each of the resource areas altered, including standards requiring consideration of alternative project design or location.

Online Users:
 Include your document transaction number (provided on your receipt page) with all supplementary information you submit to the Department.

<u>Resource Area</u>	<u>Size of Proposed Alteration</u>	<u>Proposed Replacement (if any)</u>
a. <input type="checkbox"/> Designated Port Areas	Indicate size under Land Under the Ocean, below	
b. <input type="checkbox"/> Land Under the Ocean	1. square feet _____	
	2. cubic yards dredged _____	
c. <input type="checkbox"/> Barrier Beach	Indicate size under Coastal Beaches and/or Coastal Dunes below	
d. <input type="checkbox"/> Coastal Beaches	1. square feet _____	2. cubic yards beach nourishment _____
e. <input type="checkbox"/> Coastal Dunes	1. square feet _____	2. cubic yards dune nourishment _____
	<u>Size of Proposed Alteration</u>	<u>Proposed Replacement (if any)</u>
f. <input type="checkbox"/> Coastal Banks	1. linear feet _____	
g. <input type="checkbox"/> Rocky Intertidal Shores	1. square feet _____	
h. <input type="checkbox"/> Salt Marshes	1. square feet _____	2. sq ft restoration, rehab., creation _____
i. <input type="checkbox"/> Land Under Salt Ponds	1. square feet _____	
	2. cubic yards dredged _____	
j. <input type="checkbox"/> Land Containing Shellfish	1. square feet _____	
k. <input type="checkbox"/> Fish Runs	Indicate size under Coastal Banks, inland Bank, Land Under the Ocean, and/or inland Land Under Waterbodies and Waterways, above	
	1. cubic yards dredged _____	
l. <input type="checkbox"/> Land Subject to Coastal Storm Flowage	1. square feet _____	

4. Restoration/Enhancement
 If the project is for the purpose of restoring or enhancing a wetland resource area in addition to the square footage that has been entered in Section B.2.b or B.3.h above, please enter the additional amount here.

_____ a. square feet of BWV

_____ b. square feet of Salt Marsh

5. Project Involves Stream Crossings

_____ a. number of new stream crossings

_____ b. number of replacement stream crossings

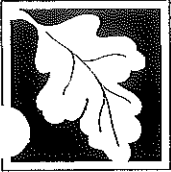

Massachusetts Department of Environmental Protection
Bureau of Resource Protection - Wetlands

WPA Form 3 – Notice of Intent

Massachusetts Wetlands Protection Act M.G.L. c. 131, §40

Provided by MassDEP:

MassDEP File Number _____

Document Transaction Number _____

Mendon _____

City/Town _____

C. Other Applicable Standards and Requirements

- This is a proposal for an Ecological Restoration Limited Project. Skip Section C and complete Appendix A: Ecological Restoration Limited Project Checklists – Required Actions (310 CMR 10.11).

Streamlined Massachusetts Endangered Species Act/Wetlands Protection Act Review

1. Is any portion of the proposed project located in **Estimated Habitat of Rare Wildlife** as indicated on the most recent Estimated Habitat Map of State-Listed Rare Wetland Wildlife published by the Natural Heritage and Endangered Species Program (NHESP)? To view habitat maps, see the *Massachusetts Natural Heritage Atlas* or go to http://maps.massgis.state.ma.us/PRI_EST_HAB/viewer.htm.

- a. Yes No **If yes, include proof of mailing or hand delivery of NOI to:**

Natural Heritage and Endangered Species Program
Division of Fisheries and Wildlife
1 Rabbit Hill Road
Westborough, MA 01581

8/1/2017 _____

b. Date of map

If yes, the project is also subject to Massachusetts Endangered Species Act (MESA) review (321 CMR 10.18). To qualify for a streamlined, 30-day, MESA/Wetlands Protection Act review, please complete Section C.1.c, and include requested materials with this Notice of Intent (NOI); *OR* complete Section C.2.f, if applicable. *If MESA supplemental information is not included with the NOI, by completing Section 1 of this form, the NHESP will require a separate MESA filing which may take up to 90 days to review (unless noted exceptions in Section 2 apply, see below).*

- c. Submit Supplemental Information for Endangered Species Review*

1. Percentage/acreage of property to be altered:

(a) within wetland Resource Area _____
percentage/acreage

(b) outside Resource Area _____
percentage/acreage

2. Assessor's Map or right-of-way plan of site

2. Project plans for entire project site, including wetland resource areas and areas outside of wetlands jurisdiction, showing existing and proposed conditions, existing and proposed tree/vegetation clearing line, and clearly demarcated limits of work **

(a) Project description (including description of impacts outside of wetland resource area & buffer zone)

(b) Photographs representative of the site

Some projects not in Estimated Habitat may be located in Priority Habitat, and require NHESP review (see <http://www.mass.gov/eea/agencies/dfg/dfw/natural-heritage/regulatory-review/>). Priority Habitat includes habitat for state-listed plants and strictly upland species not protected by the Wetlands Protection Act.

** MESA projects may not be segmented (321 CMR 10.16). The applicant must disclose full development plans even if such plans are not required as part of the Notice of Intent process.

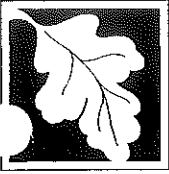

Massachusetts Department of Environmental Protection
Bureau of Resource Protection - Wetlands

WPA Form 3 – Notice of Intent

Massachusetts Wetlands Protection Act M.G.L. c. 131, §40

Provided by MassDEP:

MassDEP File Number

Document Transaction Number

Mendon

City/Town

C. Other Applicable Standards and Requirements (cont'd)

- (c) MESA filing fee (fee information available at http://www.mass.gov/dfwele/dfw/nhosp/regulatory_review/mesa/mesa_fee_schedule.htm).
Make check payable to "Commonwealth of Massachusetts - NHESP" and **mail to NHESP** at above address

Projects altering 10 or more acres of land, also submit:

- (d) Vegetation cover type map of site
- (e) Project plans showing Priority & Estimated Habitat boundaries
- (f) OR Check One of the Following

1. Project is exempt from MESA review.
Attach applicant letter indicating which MESA exemption applies. (See 321 CMR 10.14, http://www.mass.gov/dfwele/dfw/nhosp/regulatory_review/mesa/mesa_exemptions.htm; the NOI must still be sent to NHESP if the project is within estimated habitat pursuant to 310 CMR 10.37 and 10.59.)

2. Separate MESA review ongoing. a. NHESP Tracking # b. Date submitted to NHESP

3. Separate MESA review completed.
Include copy of NHESP "no Take" determination or valid Conservation & Management Permit with approved plan.

3. For coastal projects only, is any portion of the proposed project located below the mean high water line or in a fish run?

- a. Not applicable – project is in inland resource area only b. Yes No

If yes, include proof of mailing, hand delivery, or electronic delivery of NOI to either:

South Shore - Cohasset to Rhode Island border, and the Cape & Islands:

Division of Marine Fisheries -
Southeast Marine Fisheries Station
Attn: Environmental Reviewer
836 South Rodney French Blvd.
New Bedford, MA 02744
Email: DMF.EnvReview-South@state.ma.us

North Shore - Hull to New Hampshire border:

Division of Marine Fisheries -
North Shore Office
Attn: Environmental Reviewer
30 Emerson Avenue
Gloucester, MA 01930
Email: DMF.EnvReview-North@state.ma.us

Also if yes, the project may require a Chapter 91 license. For coastal towns in the Northeast Region, please contact MassDEP's Boston Office. For coastal towns in the Southeast Region, please contact MassDEP's Southeast Regional Office.

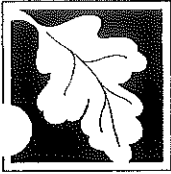

Massachusetts Department of Environmental Protection
Bureau of Resource Protection - Wetlands

Provided by MassDEP:

WPA Form 3 – Notice of Intent

Massachusetts Wetlands Protection Act M.G.L. c. 131, §40

MassDEP File Number

Document Transaction Number

Mendon

City/Town

C. Other Applicable Standards and Requirements (cont'd)

Online Users:
Include your document transaction number (provided on your receipt page) with all supplementary information you submit to the Department.

4. Is any portion of the proposed project within an Area of Critical Environmental Concern (ACEC)?
a. Yes No If yes, provide name of ACEC (see instructions to WPA Form 3 or MassDEP Website for ACEC locations). **Note:** electronic filers click on Website.
- b. ACEC
5. Is any portion of the proposed project within an area designated as an Outstanding Resource Water (ORW) as designated in the Massachusetts Surface Water Quality Standards, 314 CMR 4.00?
a. Yes No
6. Is any portion of the site subject to a Wetlands Restriction Order under the Inland Wetlands Restriction Act (M.G.L. c. 131, § 40A) or the Coastal Wetlands Restriction Act (M.G.L. c. 130, § 105)?
a. Yes No
7. Is this project subject to provisions of the MassDEP Stormwater Management Standards?
a. Yes. Attach a copy of the Stormwater Report as required by the Stormwater Management Standards per 310 CMR 10.05(6)(k)-(q) and check if:
1. Applying for Low Impact Development (LID) site design credits (as described in Stormwater Management Handbook Vol. 2, Chapter 3)
2. A portion of the site constitutes redevelopment
3. Proprietary BMPs are included in the Stormwater Management System.
b. No. Check why the project is exempt:
1. Single-family house
2. Emergency road repair
3. Small Residential Subdivision (less than or equal to 4 single-family houses or less than or equal to 4 units in multi-family housing project) with no discharge to Critical Areas.

D. Additional Information

- This is a proposal for an Ecological Restoration Limited Project. Skip Section D and complete Appendix A: Ecological Restoration Notice of Intent – Minimum Required Documents (310 CMR 10.12).

Applicants must include the following with this Notice of Intent (NOI). See instructions for details.

Online Users: Attach the document transaction number (provided on your receipt page) for any of the following information you submit to the Department.

1. USGS or other map of the area (along with a narrative description, if necessary) containing sufficient information for the Conservation Commission and the Department to locate the site. (Electronic filers may omit this item.)
2. Plans identifying the location of proposed activities (including activities proposed to serve as a Bordering Vegetated Wetland [BVW] replication area or other mitigating measure) relative to the boundaries of each affected resource area.

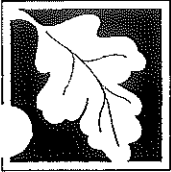

Massachusetts Department of Environmental Protection
Bureau of Resource Protection - Wetlands

Provided by MassDEP:

WPA Form 3 – Notice of Intent

Massachusetts Wetlands Protection Act M.G.L. c. 131, §40

MassDEP File Number

Document Transaction Number

Mendon

City/Town

D. Additional Information (cont'd)

3. Identify the method for BVW and other resource area boundary delineations (MassDEP BVW Field Data Form(s), Determination of Applicability, Order of Resource Area Delineation, etc.), and attach documentation of the methodology.

4. List the titles and dates for all plans and other materials submitted with this NOI.

Site Plan of Land, Mendon Self-Storage

a. Plan Title

Guerriere & Halnon, Inc.

Elizabeth Mainini, P.E.

b. Prepared By

c. Signed and Stamped by

March 3, 2020

30 scale

d. Final Revision Date

e. Scale

f. Additional Plan or Document Title

g. Date

5. If there is more than one property owner, please attach a list of these property owners not listed on this form.

6. Attach proof of mailing for Natural Heritage and Endangered Species Program, if needed.

7. Attach proof of mailing for Massachusetts Division of Marine Fisheries, if needed.

8. Attach NOI Wetland Fee Transmittal Form

9. Attach Stormwater Report, if needed.

E. Fees

1. Fee Exempt: No filing fee shall be assessed for projects of any city, town, county, or district of the Commonwealth, federally recognized Indian tribe housing authority, municipal housing authority, or the Massachusetts Bay Transportation Authority.

Applicants must submit the following information (in addition to pages 1 and 2 of the NOI Wetland Fee Transmittal Form) to confirm fee payment:

2518

3/3/20

2. Municipal Check Number

3. Check date

2519

3/3/20

4. State Check Number

5. Check date

Roy Ventures Corp.

6. Payor name on check: First Name

7. Payor name on check: Last Name

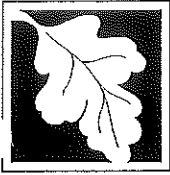

Massachusetts Department of Environmental Protection
Bureau of Resource Protection - Wetlands

WPA Form 3 – Notice of Intent

Massachusetts Wetlands Protection Act M.G.L. c. 131, §40

Provided by MassDEP:

MassDEP File Number

Document Transaction Number

Mendon

City/Town

F. Signatures and Submittal Requirements

I hereby certify under the penalties of perjury that the foregoing Notice of Intent and accompanying plans, documents, and supporting data are true and complete to the best of my knowledge. I understand that the Conservation Commission will place notification of this Notice in a local newspaper at the expense of the applicant in accordance with the wetlands regulations, 310 CMR 10.05(5)(a).

I further certify under penalties of perjury that all abutters were notified of this application, pursuant to the requirements of M.G.L. c. 131, § 40. Notice must be made by Certificate of Mailing or in writing by hand delivery or certified mail (return receipt requested) to all abutters within 100 feet of the property line of the project location.

<p>1. Signature of Applicant <i>Roy Vary</i></p>	<p>2. Date <i>3/3/2020</i></p>
<p>3. Signature of Property Owner (if different) <i>Robert J. Papp</i></p>	<p>4. Date <i>3/3/20</i></p>
<p>5. Signature of Representative (if any)</p>	<p>6. Date</p>

For Conservation Commission:

Two copies of the completed Notice of Intent (Form 3), including supporting plans and documents, two copies of the NOI Wetland Fee Transmittal Form, and the city/town fee payment, to the Conservation Commission by certified mail or hand delivery.

For MassDEP:

One copy of the completed Notice of Intent (Form 3), including supporting plans and documents, one copy of the NOI Wetland Fee Transmittal Form, and a **copy** of the state fee payment to the MassDEP Regional Office (see Instructions) by certified mail or hand delivery.

Other:

If the applicant has checked the "yes" box in any part of Section C, Item 3, above, refer to that section and the Instructions for additional submittal requirements.

The original and copies must be sent simultaneously. Failure by the applicant to send copies in a timely manner may result in dismissal of the Notice of Intent.

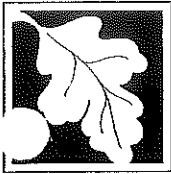

Massachusetts Department of Environmental Protection
 Bureau of Resource Protection - Wetlands
NOI Wetland Fee Transmittal Form
 Massachusetts Wetlands Protection Act M.G.L. c. 131, §40

Important: When filling out forms on the computer, use only the tab key to move your cursor - do not use the return key.



A. Applicant Information

1. Location of Project:

41 Milford Street
 a. Street Address
 Mendon
 b. City/Town
 2075
 d. Fee amount

2. Applicant Mailing Address:

Roy
 a. First Name
 Anna Corporation
 c. Organization
 P.O. Box 553
 d. Mailing Address
 Milford
 e. City/Town
 MA
 f. State
 01757
 g. Zip Code
 508-634-3176
 h. Phone Number
 royvaz74@yahoo.com
 j. Email Address

3. Property Owner (if different):

a. First Name
 b. Last Name
 c. Organization
 d. Mailing Address
 e. City/Town
 f. State
 g. Zip Code
 h. Phone Number
 i. Fax Number
 j. Email Address

To calculate filing fees, refer to the category fee list and examples in the instructions for filling out WPA Form 3 (Notice of Intent).

B. Fees

Fee should be calculated using the following process & worksheet. **Please see Instructions before filling out worksheet.**

Step 1/Type of Activity: Describe each type of activity that will occur in wetland resource area and buffer zone.

Step 2/Number of Activities: Identify the number of each type of activity.

Step 3/Individual Activity Fee: Identify each activity fee from the six project categories listed in the instructions.

Step 4/Subtotal Activity Fee: Multiply the number of activities (identified in Step 2) times the fee per category (identified in Step 3) to reach a subtotal fee amount. Note: If any of these activities are in a Riverfront Area in addition to another Resource Area or the Buffer Zone, the fee per activity should be multiplied by 1.5 and then added to the subtotal amount.

Step 5/Total Project Fee: Determine the total project fee by adding the subtotal amounts from Step 4.

Step 6/Fee Payments: To calculate the state share of the fee, divide the total fee in half and subtract \$12.50. To calculate the city/town share of the fee, divide the total fee in half and add \$12.50.

ROY VENTURES CORP.
 P.O. BOX 553
 MILFORD, MA 01757

THIS CHECK IS IN PAYMENT OF THE FOLLOWING

2519
 53-447/113

PAY Five hundred twelve ⁵⁰/₁₀₀ DOLLARS

DATE	TO THE ORDER OF	CHECK NO.	DESCRIPTION	DOLLARS
3/3	Comm of Mass	2519	NOT Filing	\$ 512.50

ROCKLAND TRUST COMPANY
 ROCKLAND, MA 02370

Roy P. Verry
Paul M. Mearns

⑆002519⑆ ⑆011304478⑆ 0026001775⑆

ROY VENTURES CORP.
 P.O. BOX 553
 MILFORD, MA 01757

THIS CHECK IS IN PAYMENT OF THE FOLLOWING

2518
 53-447/113

PAY Five hundred thirty-seven ⁵⁰/₁₀₀ DOLLARS

DATE	TO THE ORDER OF	CHECK NO.	DESCRIPTION	DOLLARS
3/3	Town of Mendon	2518	NOT	\$ 537.50

ROCKLAND TRUST COMPANY
 ROCKLAND, MA 02370

Roy P. Verry
Paul M. Mearns

⑆002518⑆ ⑆011304478⑆ 0026001775⑆

AFFIDAVIT OF SERVICE

Under the Massachusetts Wetlands Protection Act

**(to be submitted to the Massachusetts Department of
Environmental Protection and the Conservation Commission
when filing a Notice of Intent)**

I, Robert J. Poxon, hereby certify under the pains and penalties of perjury that on March 6, 2020 I gave notification to abutters in compliance with the second paragraph of Massachusetts General Laws Chapter 131, Section 40, and the DEP Guide to Abutter Notification dated April 8, 1994, in connection with the following matter:

A Notice of Intent filed under the Massachusetts Wetlands Protection Act by

Roy Vaz, Anna Corporation

with the Mendon **Conservation Commission on**

March 5, 2020 **for property located at** 41 Milford Street

The form of the notification, and a list of the abutters to whom it was given and their addresses, are attached to this Affidavit of Service.

Robert J. Poxon
Name

3/6/2020
Date

Notification to Abutters Under the
Massachusetts Wetlands Protection Act

In accordance with the second paragraph of Massachusetts General Laws Chapter 131, Section 40, you are hereby notified of the following.

- A. The name of the applicant is Roy Vaz, Anna Corporation
-
- B. The applicant has filed a Notice of Intent with the Conservation Commission for the municipality of Mendon
seeking permission to work within 100 ft. of an Area Subject to Protection Under the Wetlands Protection Act (General Laws Chapter 131, Section 40).
- C. The address of the lot where the activity is proposed is 41 Milford Street
-
- D. Copies of the Notice of Intent may be examined at The Office of Guerriere & Halnon, Inc.
333 West Street, Milford, MA
between the hours of 9 am and 3 pm on the following days of the week:
Monday - Friday
For more information, call: (508) 473-6630
- Check One: This is the applicant , representative , or other (specify):
-
- E. Copies of the Notice of Intent may be obtained from either (check one) the applicant , or the applicant's representative , by calling this telephone number: (508) 473-6630
between the hours of 9 am and 3 pm on the following days of the week:
Monday - Friday. A fee will be charged for copies
- F. Information regarding the date, time and place of the public hearing may be obtained from:
Mendon Conservation Commission
by calling telephone number (508) 634-6898 between the hours of 1 pm and 5 pm
on the following days of the week: Tuesday & Thursday
- Check one: This is the applicant , representative , or other (specify):
Mendon Conservation Commission

NOTE: Notice of the public hearing, including its date, time, and place, will be published at least five (5) days in advance in the Milford Daily News
(name of newspaper)

NOTE: Notice of the public hearing, including its date, time, and place, will be posted in the City or Town Hall not less than forth-eight (48) hours in advance.

NOTE: You also may contact your local Conservation Commission or the nearest Department of Environmental Protection Regional Office for more information about this application or the Wetlands Protection Act. To contact DEP, call:

Central Region: 508-792-7650
Southeast Region: 508-946-2800

Northeast Region: 617-935-2160
Western Region: 413-784-1100

ABUTTERS



TOWN OF MENDON
BOARD OF ASSESSORS
20 MAIN STREET
MENDON, MA 01756
508-473-2738
508-478-8241 (Fax)
e-mail: jberthold@mendonma.gov

February 18, 2020

*PROPERTY LOCATION(S): 41 Milford Street
Mendon, Massachusetts
Assessor's Map #9-177-41*

PROPERTY OWNER(S): Anna Corporation

*OWNER(S) ADDRESS: P. O Box 553
Milford, MA 01757*

*RECORDED: Worcester Registry of Deeds
July 1, 1997
Book #18965
Page #190*

The attached 100' abutter's list is true and accurate to the best of our knowledge.

Sincerely,

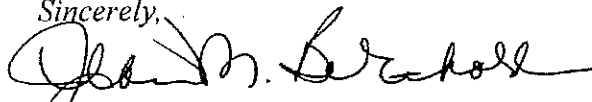
*Jean M. Berthold, MAA
Principal Assessor*

Attachment

TOWN OF MENDON, MA
 BOARD OF ASSESSORS
 20 Main Street, Mendon, MA 01756

Abutters List Within 100 feet of Parcel 9/177/41/0

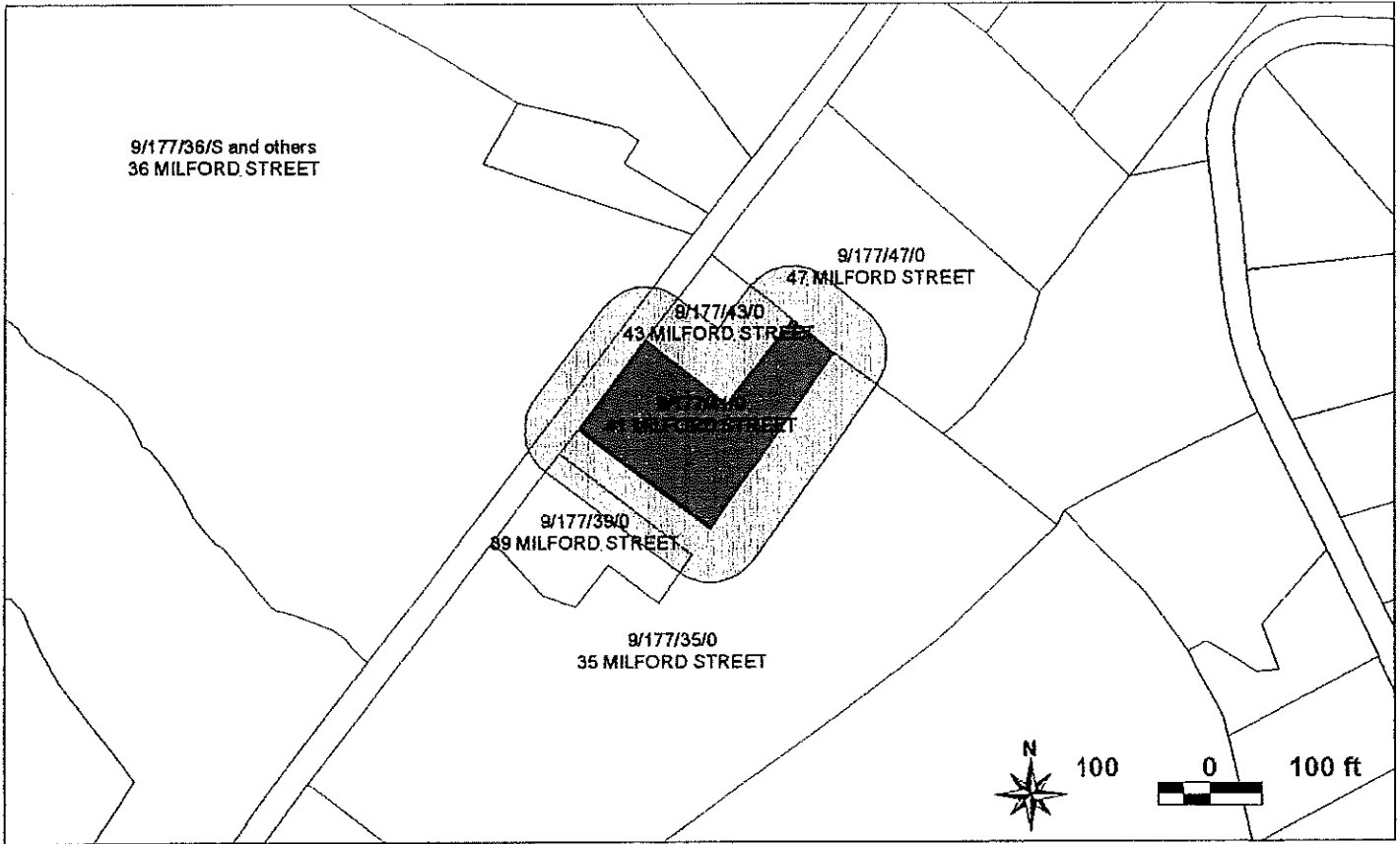

Key	Parcel ID	Owner	Location	Mailing Street	Mailing City	ST	ZipCd/Country
555	9-177-35-0-R	PURPLE POWER LLC	35 MILFORD STREET	P O BOX 277	ALLSTON	MA	02134
556	9-177-36-0-E	TOWN OF MENDON	36 MILFORD STREET	20 MAIN STREET	MENDON	MA	01756
3520	9-177-36-S-R	TOWN OF MENDON C/O BWC MYSTIC RIVER LLC	36 MILFORD STREET	AMERESCO - SHERRIE BROGAN 111 SPEEN ST - STE 410	FRAMINGHAM	MA	01701
557	9-177-39-0-R	ANNA CORPORATION	39 MILFORD STREET	P. O. BOX 553	MILFORD	MA	01757
558	9-177-41-0-R	ANNA CORPORATION	41 MILFORD STREET	P. O. BOX 553	MILFORD	MA	01757
560	9-177-43-0-R	WORCESTER COUNTY ELECTRIC CO C/O PROPERTY TAX DEPARTMENT	43 MILFORD STREET	40 SYLVAN ROAD	WALTHAM	MA	02451-2286
562	9-177-47-0-R	SPINNEY PROPERTIES LLC	47 MILFORD STREET	47 MILFORD STREET	MENDON	MA	01756

Exhibit A

Portion of USGS Map Showing Locus

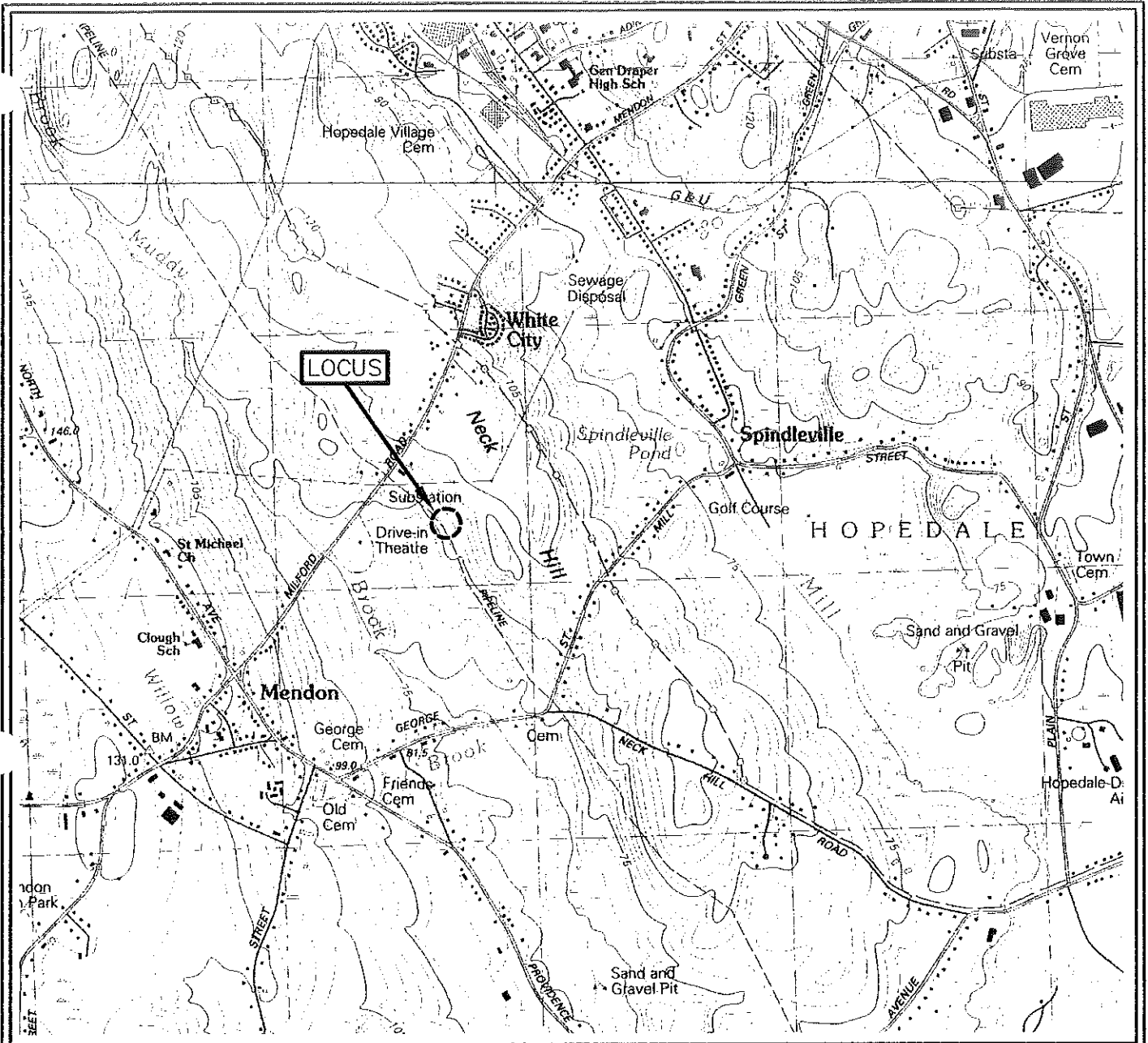

U.S.G.S.
Quadrangle

Scale: 1"=2000'

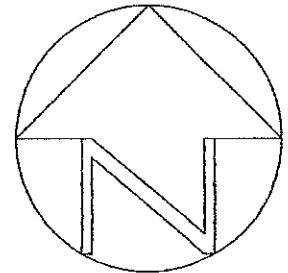

LOCUS MAP
41 Milford Street
Mendon, Massachusetts



**Guerriere
&
Halnon, Inc.**

Engineering & Land Surveying
333 WEST STREET, MILFORD, MA 01757
(508) 473-6630 FAX: (508) 473-8243
WWW.GUERRIEREANDHALNON.COM

Date: March 3, 2020

Project No. G-7532

Exhibit B
Wetlands Delineation Report

September 18, 2018

Roy Vaz
PO Box 553
Milford, MA 01757

Re: 41 Milford Street, Mendon

Dear Mr. Vaz:

In the summer of 2018 Scott Goddard inspected the above referenced site and the wetland resources areas were delineated. The wetland border was flagged using the criteria in the most recent edition of MA Wetland Protection Act (WPA) and Regulations 310 CMR 10.00 et al and the Town of Mendon Wetland Bylaw. Hydric soil indicators, vegetation changes, hydrological indicators, and topography were all considered for delineation purposes.

One Bordering Vegetated Wetland was delineated on site with series GC1-21. This wetland is dominant in red maple, highbush blueberry, buckthorn, spicebush, poison ivy and wetland ferns. The adjacent upland is dominant in oak, white pine, honeysuckle, black huckleberry, rose, cherry and upland herbs. Department of Environmental Protection BVW field data forms were documented at wetland flag # GC-19 (see attached forms).

According to the Mass GIS data layers for NHESP, this site not is located within Estimated and/or Priority Habitat of Rare Wildlife, and no mapped potential or certified vernal pools are located on site. The site is not located in an ACEC; or a jurisdictional FEMA Flood Zone.

The MA Wetlands Protection Act and the local bylaw takes jurisdiction over BVW and its jurisdictional 100-foot Buffer Zone. Any work within the resource area and/or 100-foot buffer zone requires a Request for Determination (RDA) or Notice of Intent (NOI) be filed with the Conservation Commission. If you need further assistance with permitting, please call us we would be happy to assist.

Very truly yours,

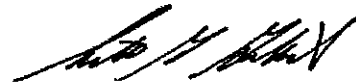

Scott Goddard,
Principal & PWS

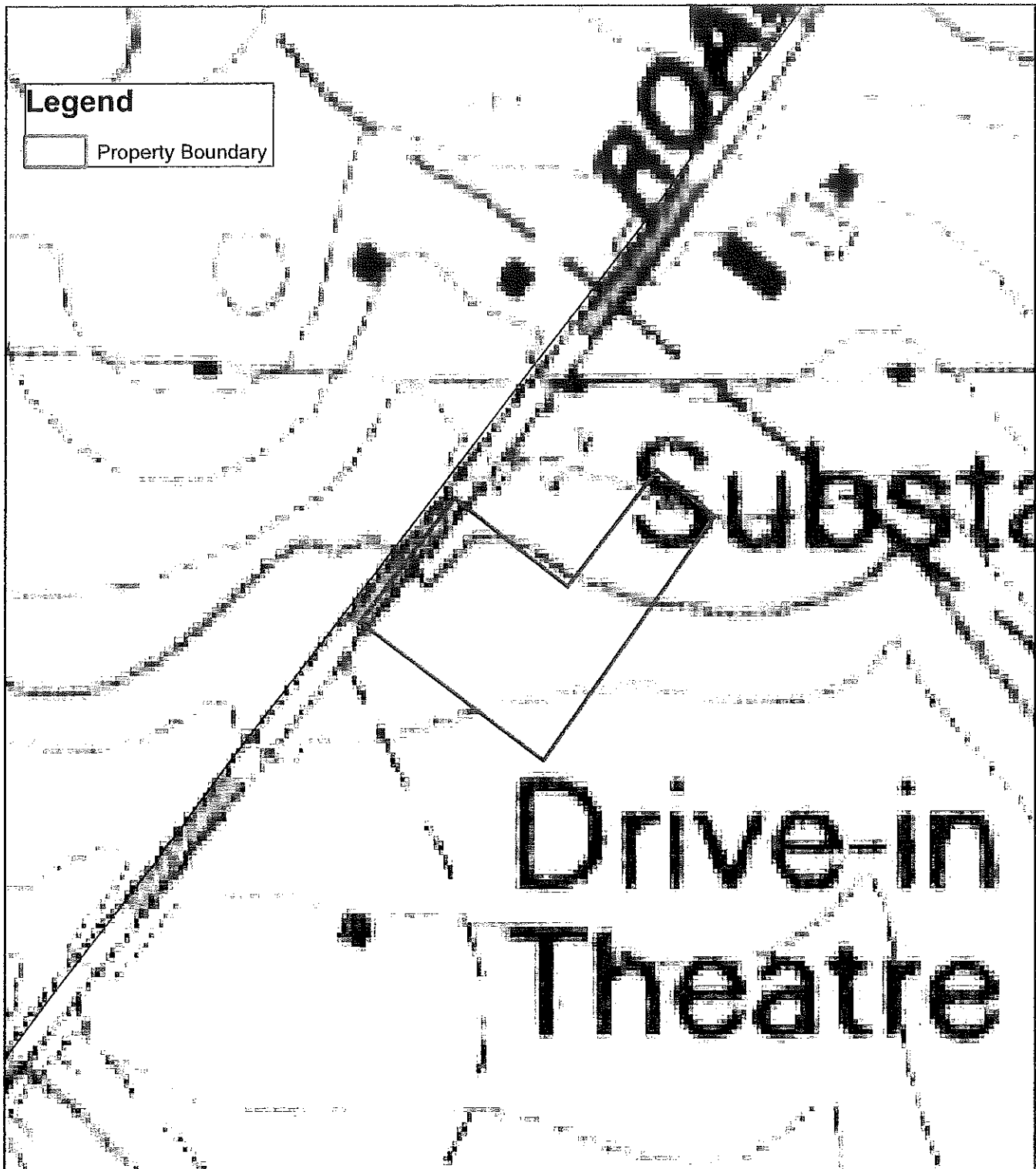

USGS Site Locus
Milford Street Mendon, MA

N
0 100 200
Feet
1 inch = 200 feet
Date: 7/2/18

GIS Data Source: "Office of Geographic Information (MassGIS), Commonwealth of Massachusetts, MassIT"

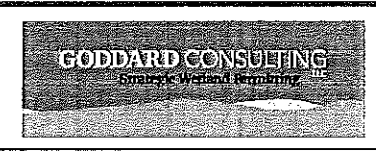

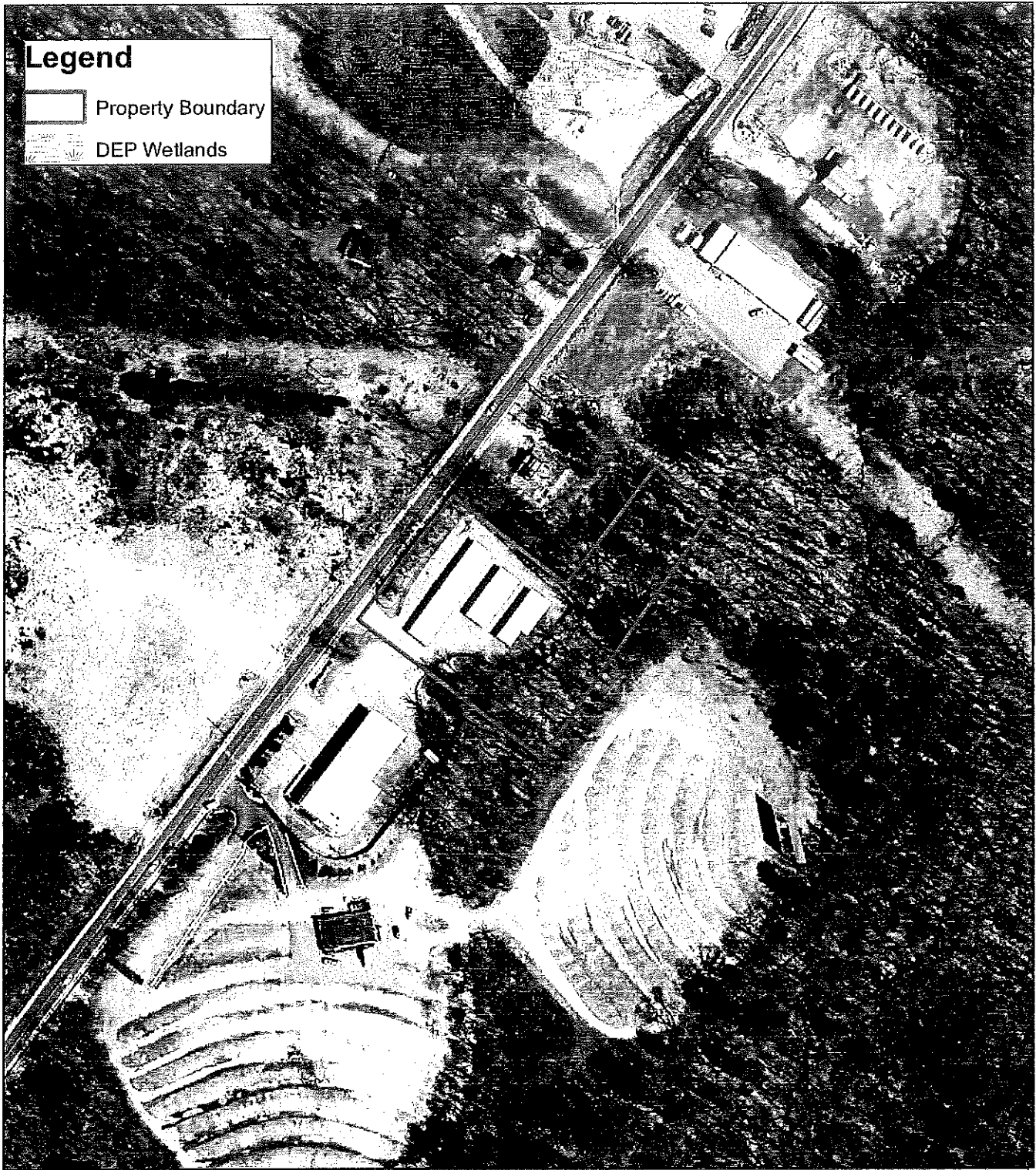

Legend

Property Boundary

DEP Wetlands

Ortho View of Site
 Milford Street Mendon, MA

N

0 100 200 Feet

1 inch = 200 feet

Date: 7/2/18

GIS Data Source: "Office of Geographic Information (MassGIS), Commonwealth of Massachusetts, MassIT"

GODDARD CONSULTING
 Strategic Wetland Permitting

Section II. Indicators of Hydrology

Hydric Soil Interpretation

1. Soil Survey

Is there a published soil survey for this site? yes no
 title/date: Soil Survey of Worcester County, Southern Part - 1998

map number: _____

soil type mapped: Canton fine sandy loam

hydric soil inclusions: _____

Are field observations consistent with soil survey? yes no

Remarks: _____

2. Soil Description

Horizon	Depth (inches)	Matrix Color	Mottles Color or Texture
A	1-10	10YR2/2	
B	10-20	10YR5/4	

Remarks: _____

3. Other: _____

Conclusion: Is soil hydric? yes no

Other Indicators of Hydrology: (check all that apply and describe)

Site inundated: _____

Depth to free water in observation hole: _____

Depth to soil saturation in observation hole: _____

Water marks: _____

Drift Lines: _____

Sediment deposits: _____

Drainage patterns in BVW: _____

Oxidized rhizospheres: _____

Water-stained leaves: _____

Recorded data (stream, lake, or tidal gauge; aerial photo; other): _____

Other: _____

Vegetation and Hydrology Conclusion for Upgradient of Gc-19

Number of wetland indicator plants
 >= number of non-wetland plants

yes no

X

Wetland hydrology present:

hydric soils present

X

other indicators of hydrology present

X

Sample location is in a BVW

X

Submit this form with the Request for Determination of Applicability or Notice of Intent

DEP Bordering Vegetated Wetland (310 CMR 10.55) Delineation Field Data Form

DEP File #:

Prepared by: Goddard Consulting LLC Project location: 41 Milford Rd, Mendon

Applicant: Vegetation alone presumed adequate to delineate BVW boundary: fill out Section I only
 Vegetation and other indicators of hydrology used to delineate BVW boundary: fill out Sections I and II
 Method other than dominance test used (attach additional information)

Section I. Vegetation		Transect Number: <u>Upgradient</u>	Date of Delineation: <u>20-Jul-18</u>	Wetland Indicator Category*
Sample Layer and Plant Species	Scientific name	% Cover	% Dominance	Dominant Plant (yes or no)
<i>Tree Layer</i>				
Red Oak	<i>Quercus rubra</i>	20%	33.3%	Yes
White pine	<i>Pinus strobus</i>	10%	16.7%	No
Northern white oak	<i>Quercus alba</i>	20%	33.3%	Yes
Red maple	<i>Acer rubrum</i>	10%	16.7%	No
<i>Sapling Layer</i>				
<i>Shrub Layer</i>				
Black cherry	<i>Prunus serotina</i>	10%	100.0%	Yes
<i>Climbing Woody Vine</i>				
Horse brier	<i>Smitax rotundifolia</i>	10%	100.0%	yes
<i>Ground Cover</i>				
Canada mayflower	<i>Maianthemum canadense</i>	10%	100.0%	Yes

Remarks: * An asterisk after common plant name indicates stunted growth; ** indicates extremely stunted growth

Description:

Morphological Adaptations: 0
 * An asterisk after indicator status denotes wetlands plants: plants listed in the Wetlands Protection Act (MGL c.131, s.40); plants in the genus Sphagnum; or plants listed as FAC, FACW, or OBL.

Vegetation conclusion:

Number of dominant wetland indicator plants: 1 Number of dominant non-wetland indicator plants: 4

Is the number of dominant wetland plants equal to or greater than the number of dominant non-wetland plants? no

If vegetation alone is presumed adequate to delineate the BVW boundary, submit this form with the Request for Determination of Applicability or Notice of Intent.

Section II. Indicators of Hydrology

Hydric Soil Interpretation

1. Soil Survey

Is there a published soil survey for this site? yes no

title/date: Soil Survey of Worcester County, Southern Part - 1998
map number: _____

soil type mapped: Canton fine sandy loam

hydric soil inclusions: Swansea fine sandy loam

Are field observations consistent with soil survey? yes no

Remarks: _____

2. Soil Description

Horizon	Depth (inches)	Matrix Color	Mottles Color or Texture
O	1-10	10YR2/1	
C	10-20	10YR6/1	

Remarks: _____

3. Other:

Conclusion: Is soil hydric? yes no

Other Indicators of Hydrology: (check all that apply and describe)

- Site inundated: _____
- Depth to free water in observation hole: _____
- Depth to soil saturation in observation hole: _____
- Water marks: _____
- Drift Lines: _____
- Sediment deposits: _____
- Drainage patterns in BVW: _____
- Oxidized rhizospheres: _____
- Water-stained leaves: _____
- Recorded data (stream, lake, or tidal gauge; aerial photo; other): _____
- Other: _____

Vegetation and Hydrology Conclusion for Downgradient of Gc-19

Number of wetland indicator plants
>= number of non-wetland plants yes no

Wetland hydrology present:
hydric soils present yes no

other indicators of hydrology
present yes no

Sample location is in a BVW yes no

Submit this form with the Request for Determination of Applicability or Notice of Intent

DEP Bordering Vegetated Wetland (310 CMR 10.55) Delineation Field Data Form

DEP File #:

Prepared by: Godard Consulting LLC
Project location: 41 Milford Rd, Mendon

Applicant: Vegetation alone presumed adequate to delineate BVW boundary: fill out Section I only
 Vegetation and other indicators of hydrology used to delineate BVW boundary: fill out Sections I and II
 Method other than dominance test used (attach additional information)

Section I. Vegetation	Observation Plot Number: <u>Gc-19</u>	Transect Number: <u>Downgradient</u>	Date of Delineation: <u>20-Jul-18</u>	Wetland Indicator Category*
Sample Layer and Plant Species	Scientific name	% Cover	% Dominance	Dominant Plant (yes or no)
<u>Tree Layer</u> Red Maple	<i>Acer rubrum</i>	36%	100.0%	Yes FAC*
<u>Sapling Layer</u> Red maple Tupelo	<i>Acer rubrum</i> <i>Nyssa sylvatica</i>	10% 10%	50.0% 50.0%	Yes Yes FAC* FAC*
<u>Shrub Layer</u> Sweet pepperbush Highbush blueberry Northern arrowwood	<i>Clethra alnifolia</i> <i>Vaccinium corymbosum</i> <i>Viburnum racematum</i>	10% 10% 10%	33.3% 33.3% 33.3%	Yes Yes Yes FAC* FACW* FAC*
<u>Climbing Woody Vine</u> Eastern poison ivy Horse brier	<i>Toxicodendron radicans</i> <i>Smilax rotundifolia</i>	10% 10%	50.0% 50.0%	Yes Yes FAC* FAC*
<u>Ground Cover</u> Sweet pepperbush Cinnamon fern	<i>Clethra alnifolia</i> <i>Osmundastrum cinnamomeum</i>	10% 10%	50.0% 50.0%	Yes Yes FAC* FACW*

Remarks: * An asterisk after common plant name indicates stunted growth; ** indicates extremely stunted growth

Morphological Adaptations: 0

* An asterisk after indicator status denotes wetlands plants: plants listed in the Wetlands Protection Act (MGL c.131, s.40); plants in the genus Sphagnum; or plants listed as FAC, FACW, or OBL.

Vegetation conclusion: Number of dominant non-wetland indicator plants: 0

Number of dominant wetland indicator plants: 10

Is the number of dominant wetland plants equal to or greater than the number of dominant non-wetland plants? yes

If vegetation alone is presumed adequate to delineate the BVW boundary, submit this form with the Request for Determination of Applicability or Notice of Intent.

Exhibit C
Resource Area Plan